

MASS-TER MOVER[®]

MODEL 50 & 85 PORTABLE



Model 85
90' Unit Shown



Complimented by Comparison



HUTCHINSON PO

The MASS-TER MOVER line is Hutchinson's answer to "en masse" conveying systems. You get top performance, long life and reliability with minimum maintenance engineered into each component.

MASS-TER® MOVER FEATURES

- Requires less horsepower than a screw conveyor.
- En masse (grain-moving-grain) concept causes less damage to grain at higher capacities and needs less maintenance than traditional conveying systems.
- Unique UHMW paddle, designed to keep your grain flowing smoothly and evenly from inlet to discharge.



PTO DRIVE

The PTO drive provides a shear mechanism into the PTO driveline for component protection.



ELECTRIC DRIVE

Electric drive arrangement shown with optional 12" inlet hopper extension.



HYDRAULIC DRIVE

The hydraulic drive provides a dependable means of conveying grain through the conveyor. A variety of options are available for se

PORTABLE MASS-TER® MOVER

Damage
less than
moving gently

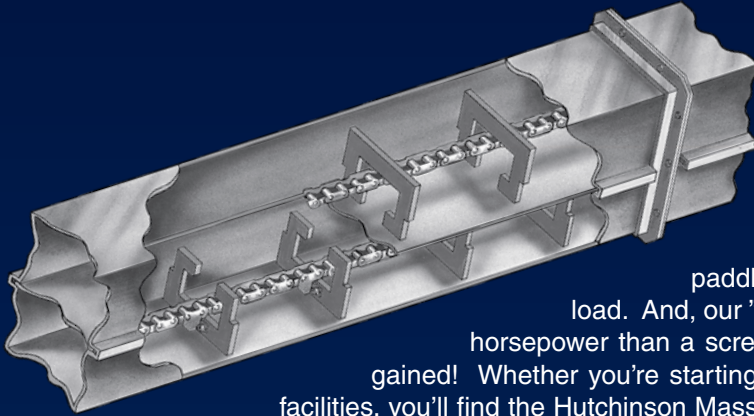

MASS-TER® MOVER'S UNIQUE CHAIN AND PADDLE DESIGN

The unique shape of tough UHMW paddles maintains full chamber movement of grain . . . without fall-back. The open centers of the paddles provide relief when starting under a full load. And, our "square paddle" propulsion system requires less horsepower than a screw conveyor—up to 30% energy savings can be gained! Whether you're starting from the ground up, or updating your present facilities, you'll find the Hutchinson Mass-ter Mover® ready to meet your demands.



ELECTRIC WINCH SYSTEM

winch that is standard provides a smooth method to raise and lower. An optional electric winch is selected lengths.

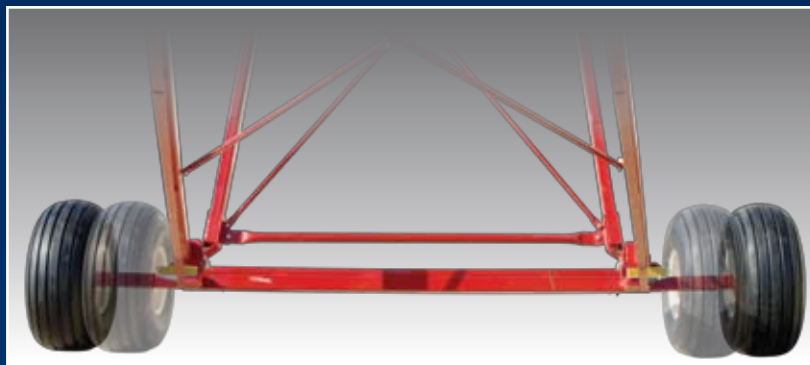

EXPANDABLE AXLE PROVIDES STABILITY AND MORE CONVENIENT TRANSPORT WIDTH

EXPANDABLE AXLE

Available on Model 85 – 80' and 90' units

HUTCHINSON MASS-TER® MOVER

MASS-TER MOVER PORTABLE 50 SPECIFICATIONS	
Dimensions of Conveying Chamber	6" x 9"
Capacity (Maximum)	5,000 BPH
Chain Travel Speed	300 FPM
Gauge of Bottom	12 Ga. Galv.
Gauge of Partition	12 Ga. Galv.
Paddles	3/8" UHMW
Conveyor Chain	81X
Drive Options	Electric or PTO
Conveyor Lengths	40', 50', 60', 65', 70', 80', 90' & 100'
Extendable Axles	Not available

MASS-TER MOVER PORTABLE 85 SPECIFICATIONS	
Dimensions of Conveying Chamber	7" x 13"
Capacity (Maximum)	8,000 to 10,000 BPH
Chain Travel Speed	400 FPM
Gauge of Bottom	10 Ga. Galv.
Gauge of Partition	12 Ga. Galv.
Paddles	1/2" UHMW
Conveyor Chain	81XHH
Drive Options	Electric or PTO
Conveyor Lengths	40', 65', 70', 80' and 90'
Extendable Axles	Standard on 80' and 90'

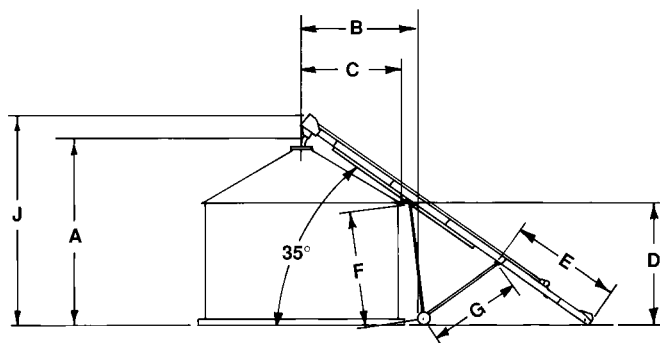

MODEL 50 MASS-TER MOVER®

	A ₁	A ₂	B	C	D	E	F	G	H	J
40'	24'-0"	22'-4"	13'-0"	12'-0"	14'-2"	12'-8"	12'-8"	10'-2"	8'-2"	12'-6"
50'	34'-0"	27'-1"	16'-5"	15'-1"	17'-8"	15'-11"	16'-7"	13'-1"	8'-9"	14'-7"
60'	40'-7"	32'-6"	22'-10"	22'-2"	18'-0"	16'-6 1/2"	17'-0"	14'-2"	8'-9"	15'-0"
65'	44'-1"	35'-4"	23'-9"	22'-10"	20'-11"	16'-6 1/2"	20'-0"	17'-0"	8'-9"	16'-0"
70'	43'-1"	38'-3"	28'-4"	26'-6"	21'-3"	18'-5"	20'-3 1/2"	16'-0"	10'-11"	15'-2"
80'	49'-6"	43'-11"	32'-5"	31'-6"	23'-4"	20'-6 1/2"	22'-5"	18'-8 1/2"	11'-11"	17'-2"
90'	55'-11"	49'-8"	35'-3"	34'-9"	26'-6"	22'-3 1/2"	24'-8"	21'-11 1/4"	14'-3"	17'-6"
100'	62'-4"	55'-5"	41'-10"	42'-4"	27'-6"	26'-10"	26'-4"	22'-5"	14'-3"	21'-1"

MODEL 85 MASS-TER MOVER®

	A ₁	A ₂	B	C	D	E	F	G	H	J
40'	24'-4"	21'-6"	14'-2"	13'-0"	14'-1"	10'-1"	12'-4"	10'-3"	9'-0"	12'-1"
65'	40'-5"	35'-10"	24'-1"	24'-1"	20'-7"	15'-10"	18'-3"	17'-3"	12'-0"	14'-1"
70'	43'-8"	38'-9"	25'-9"	25'-9"	22'-4"	17'-8"	20'-2"	18'-6"	12'-0"	15'-4"
80'	50'-3"	44'-7"	27'-9"	27'-9"	26'-10"	19'-9"	23'-9"	22'-10"	11'-8"	16'-5"
90'	57'-3"	50'-4"	31'-5"	31'-5"	30'-0"	23'-0"	27'-0"	25'-3"	11'-8"	17'-6"

A₁ Maximum discharge height (Approx. 45°)

A₂ Discharge height at 35°

B Closest point to bin at 35° (Ground level)

C Closest point to bin at 35° (Eave level)

D Free clearance above wheels

E Intake to lower arm attachment

F Upper undercarriage arm length

G Lower undercarriage arm length

H Tread width center of tire

J* Over all height in transport position

*Transport height will be lower when attached to drawbar of towing vehicle.

Call Toll-Free

1-800-523-6993

For more information.



Distributed by:

A Division of **GLOBAL** Industries, Inc.
 P.O. Box 629 • Clay Center, KS 67432
 Ph. (785) 632-2161 • FAX (785) 632-5964
www.hutchinson-mayrath.com